



CANCELLED 0/3
31-12-90

NATIONAL STANDARDS COMMISSION

WEIGHTS & MEASURES (PATTERNS OF INSTRUMENTS) REGULATIONS

REGULATION 9

SUPPLEMENTARY CERTIFICATE OF APPROVAL No S120

This is to certify that an approval has been granted by the Commission that the pattern and variants of the

Avery Model 8781 Load Cell of 2000 kg Capacity

submitted by Avery Australia Limited,
3-5 Birmingham Avenue,
Villawood, New South Wales, 2163,

are suitable for use for trade when used in a Commission-approved weighing instrument.

The approval of the pattern and variants is subject to review on or after 30/4/86.

All instruments modified by the fitting of a load cell purporting to comply with this approval shall be marked NSC No S120, in addition to the approval number of the unmodified pattern.

Relevant drawings and specifications are lodged with the Commission.

Conditions of Approval

1. The number of scale intervals applicable to the whole instrument will be no greater than the number of verified scale intervals approved for the basework, or the load cell, or the headwork, whichever is the smallest.
2. The load cells to be used shall be subject to regular certification by the National Standards Commission.

Signed

Executive Director

Descriptive Advice

Pattern: approved 7/5/81

. Avery Model 8781 load cell of 2000 kg capacity.

Technical Schedule No S120 dated 5/6/81 describes the pattern.

5/6/81



NATIONAL STANDARDS COMMISSION

TECHNICAL SCHEDULE No S120

Pattern: Avery Model 8781 Load Cell of 2000 kg capacity

Submittor: Avery Australia Limited,
3-5 Birmingham Avenue,
Villawood, New South Wales, 2163.

1. Description of Pattern

The pattern is an Avery Model 8781 load cell of 2000 kg capacity (Figure 1 and Table 1) assembled in a Commission approved basework.

1.1 Method of Mounting

1.1.1 Mounting is to be as shown in Figure 2 with a minimum free length of 200 mm.

1.1.2 The load cell cable is to be terminated in a junction box (Figures 3 and 4).

1.2 Marking

The following is the minimum of data required to be marked on the load cell:

Manufacturer's name
Model number
Serial number
Output in the form: mV/V
Maximum rated capacity

TABLE 1

Type	8781
Capacity	2000 kg
Maximum number of verification scale intervals	2000
Minimum dead load	130 kg
Minimum measuring range	800 kg
Maximum measuring range	2000 kg

Avery Model 8781 Load Cell - approved capacity

FIGURE S120 - 1

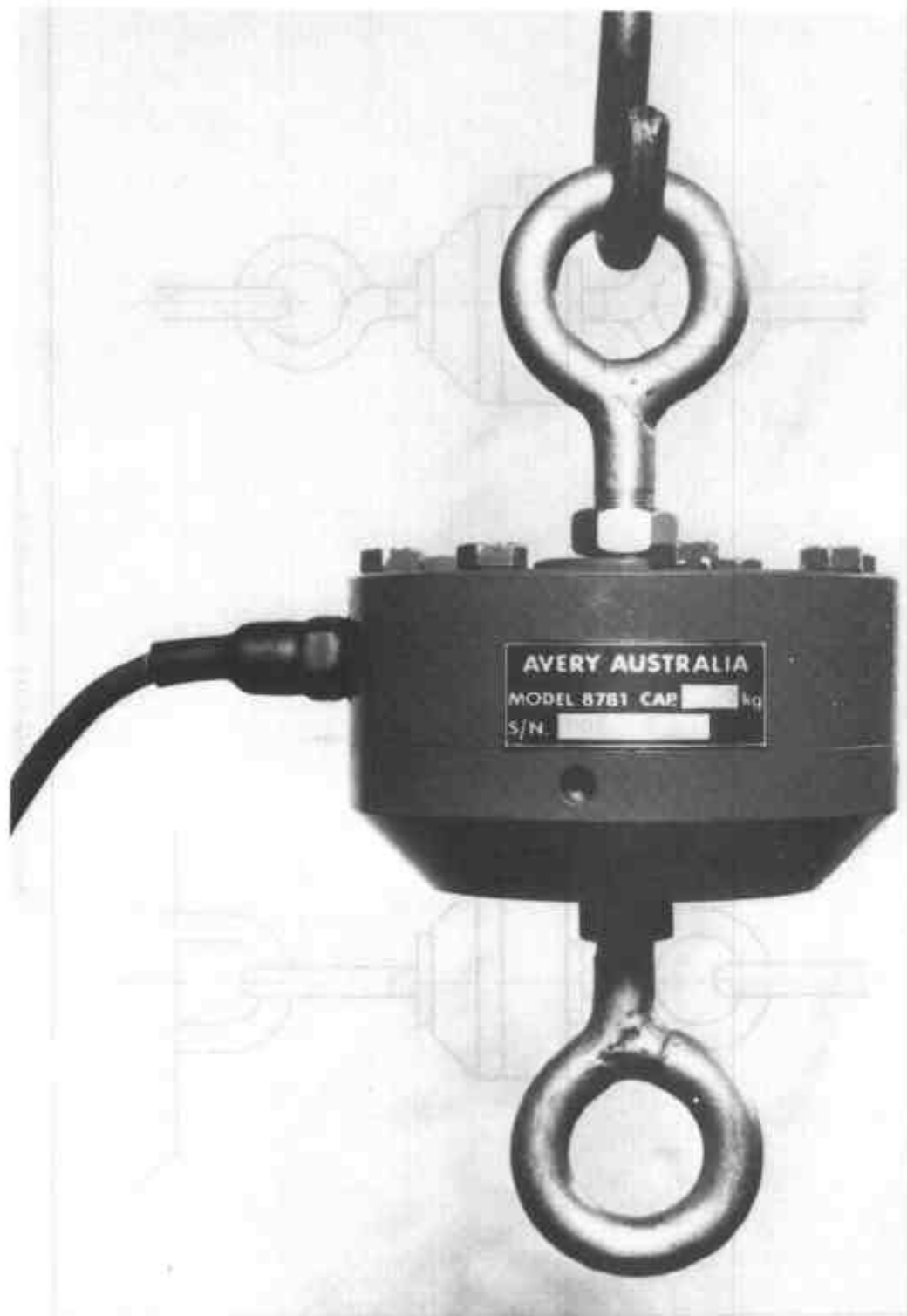

Avery Load Cell 8781

5/6/81

FIGURE S120 - 2

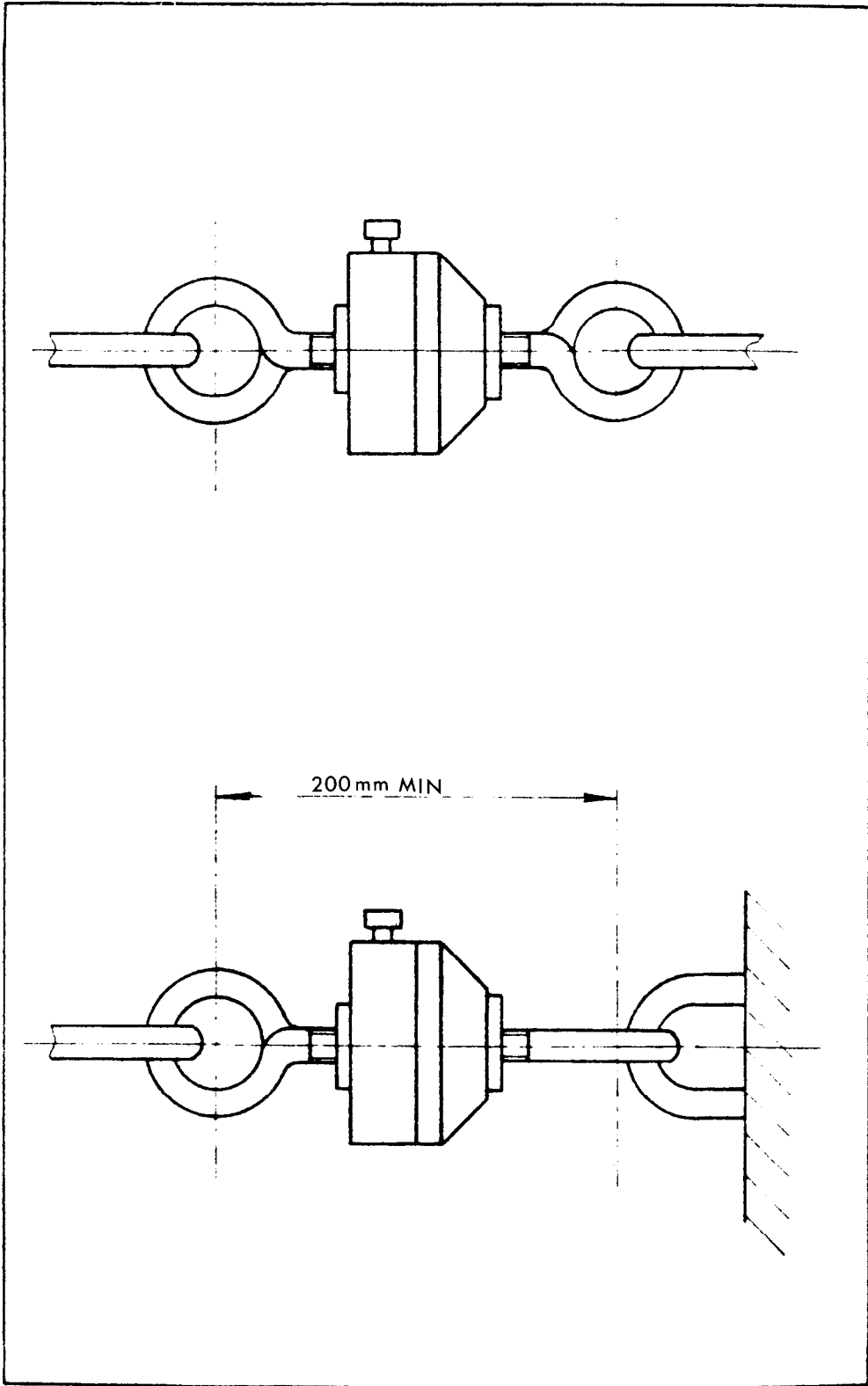

Mounting of Load Cell - Schematic Diagram

FIGURE S120 - 3

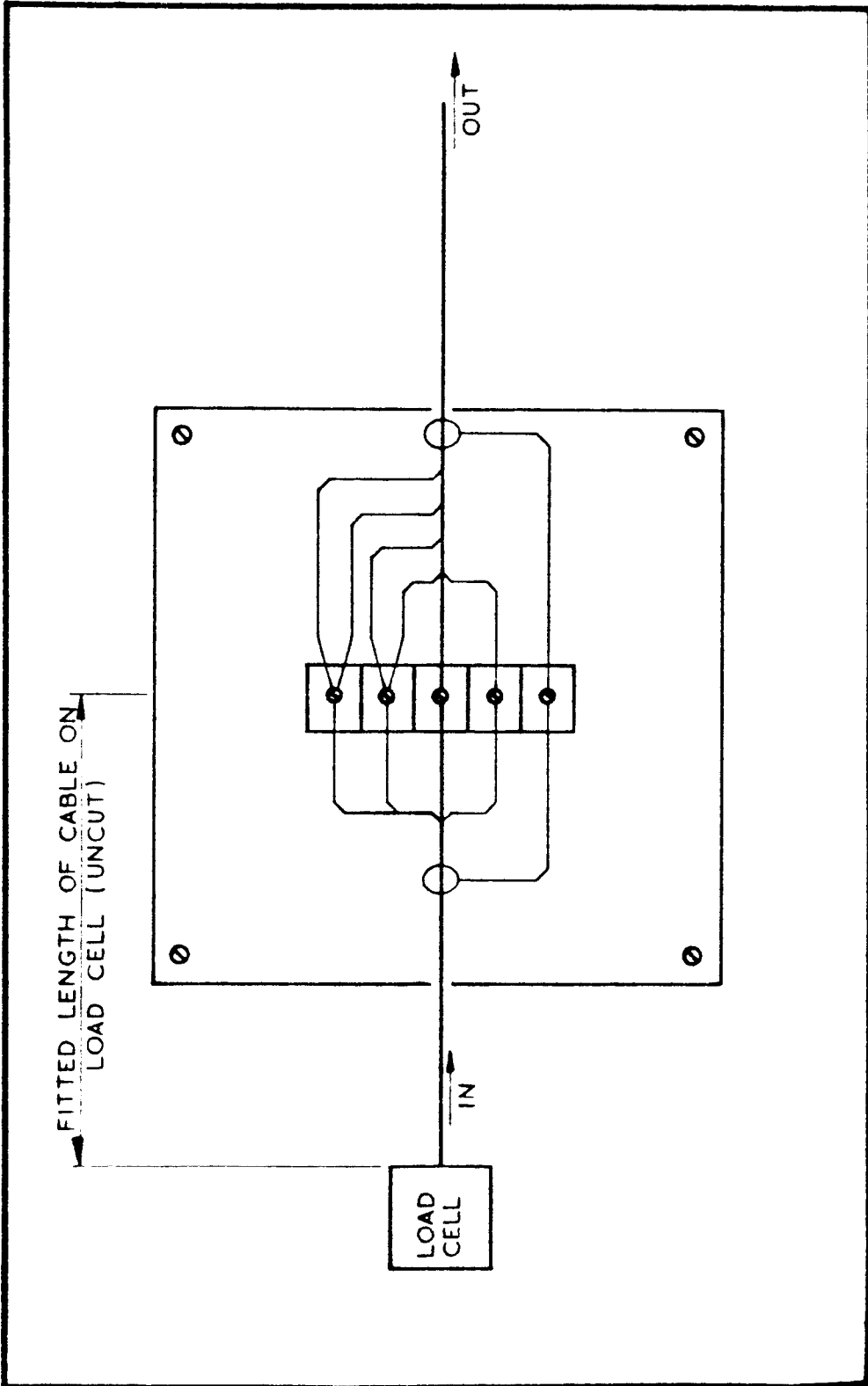

Junction Box - Schematic Diagram

FIGURE S120 - 4

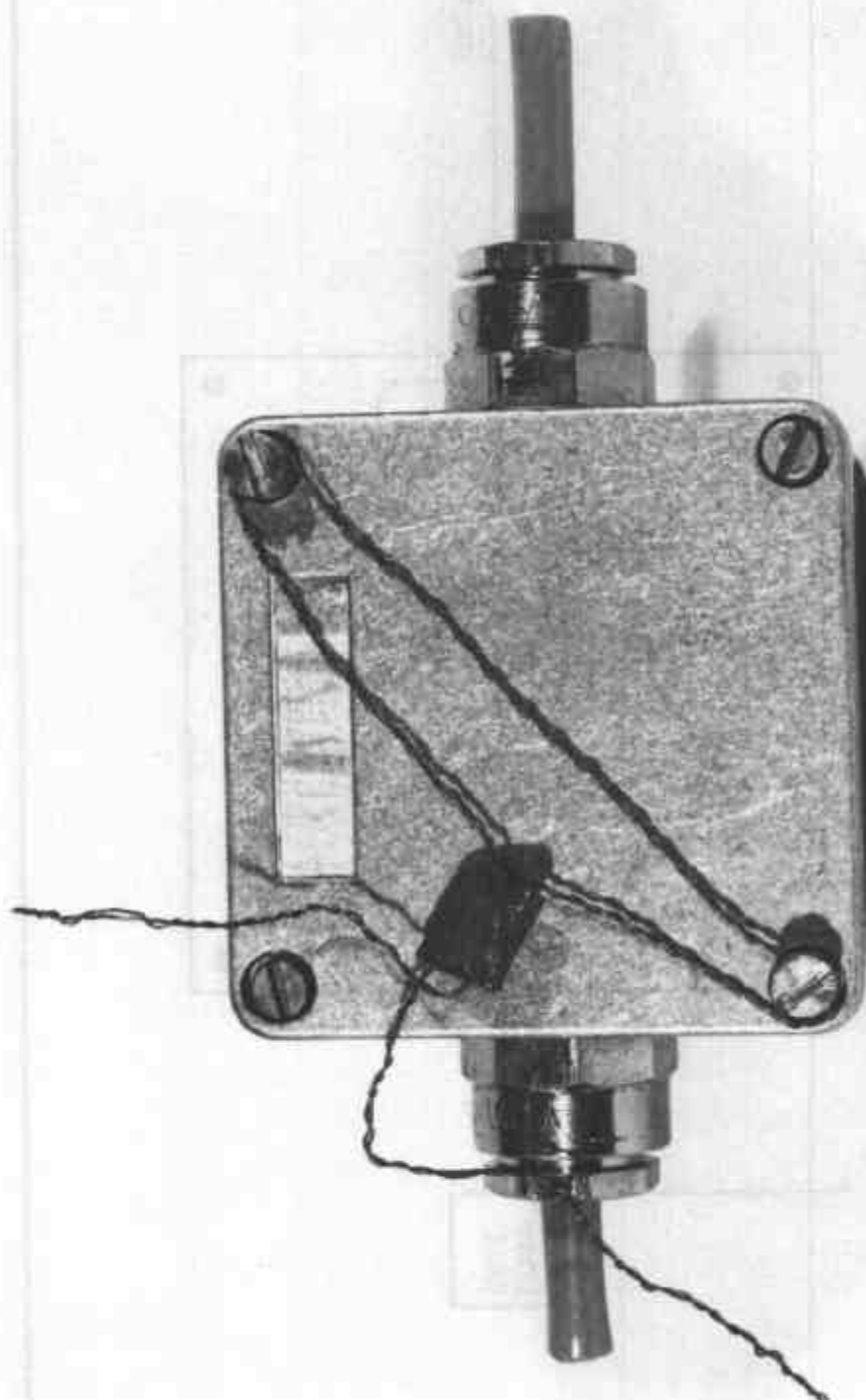

Junction Box

5/6/81